

N. H. College Bramhapuri, Dist.: Chandrapur

Center for Higher Learning and Research (CHLR)

Post Graduate Department of Physics

INFRASTRUCTURE & FACILITY

LABORATORY DIMENSION

Lab. No.	Description	Dimension (Feet)	Area (Sq. feet)	Total Area (Sq. feet)
1	UG Lab I	35.33 × 22.33	788.91	4435.49
2	UG Lab II	30.50 × 22.33	681.06	
3	UG Lab III	43.33 × 25	1083.25	
4	Dark Room	22.33 × 18.16	405.51	
5	PG Lab I	15.50 × 14.50	224.75	
6	PG Lab II	26.66 × 22.33	595.31	
7	Research Lab I	12 × 7.66	91.92	
8	Research Lab II	22.33 × 11	245.63	
9	Central Inst. Room	25.25 × 7.50	189.37	
11	Head & Staff Room	14.42 × 9	129.78	

DEPARTMENT LAYOUT

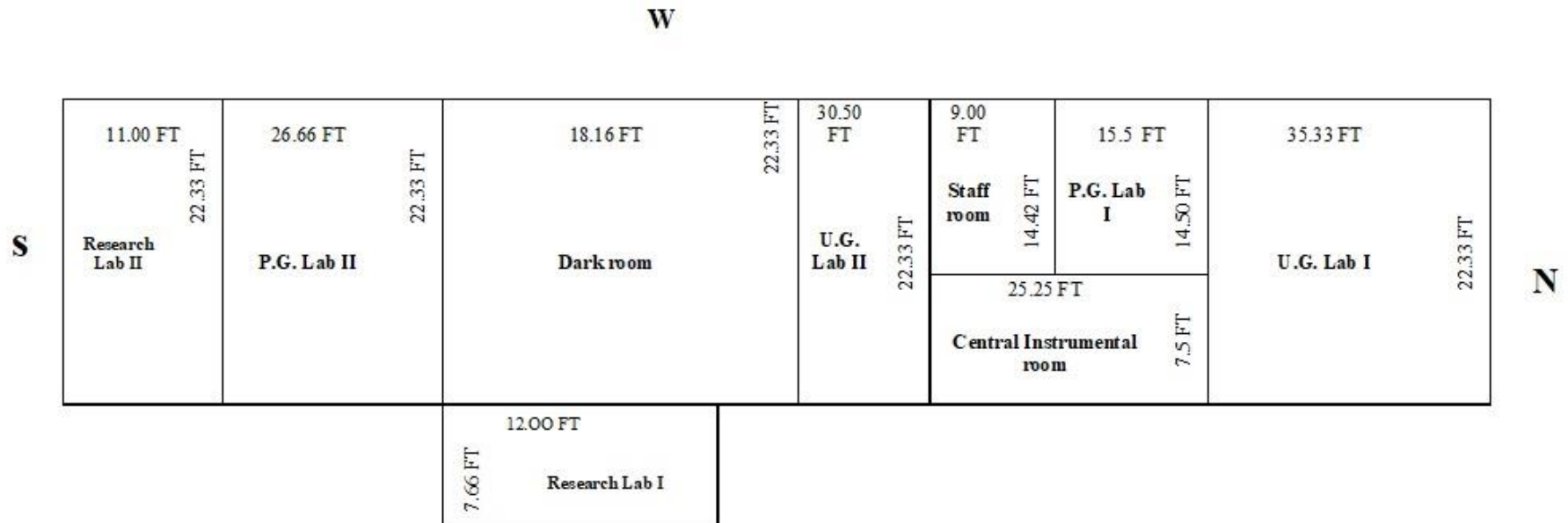

Physics Department Layout

AUDIO-VISUAL AIDS

1. OVER-HEAD PROJECTOR
2. SLIDE PROJECTOR
3. PC WITH SCANNER AND PRINTER
4. LCD PROJECTOR

SOME MAJOR INSTRUMENTS IN LABORATORY

1. CATHODE RAY OSCILLOSCOPE (CRO)
2. 800⁰ C, 1000⁰C, 1200⁰C TEMPERATURE FURNACE
3. DIGITAL MONOPAN BALANCE
4. STUDY OF LASER BY DIFFRACTION GRATING
5. FOUR PROBE APPARATUS
6. HALL EFFECT
7. SUSCEPTIBILITY MEASUREMENT APPARATUS
8. DIELECTRIC MEASUREMENT APPARATUS
9. SPECTROMETERS
10. NEWTON'S RING APPARATUS
11. THERMOCOUPLE
12. DOUBLE DISTILLATION WATER PLANT
13. DIGITAL ELECTRONIC BALANCE
14. MONOPAN BALANCE
15. MAGNETIC STIRRER
16. Ph METER
17. CHEMICALS OF GR/AR GRADE

DEPARTMENTAL LIBRARY

S.N.	PARTICULARS	QUANTITY
1	Library Books	138
2	PG Project Report	70
3	Ph.D. Thesis	3